



magazine

official PLAYbook of the LEGO® Club

July - August 2004

CALLING ALL AGENTS...

Alpha Team Needs you!

ULTIMATE VAHKI!

Surrender or Run!

MESOZOIC MONSTER!

Complete Building Steps!

**Knights
Kingdom**



Presorted Standard
U.S. Postage
PAID
LEGO Credit

LEGO Club, P.O. Box 1157, Enfield, CT 06033-1157

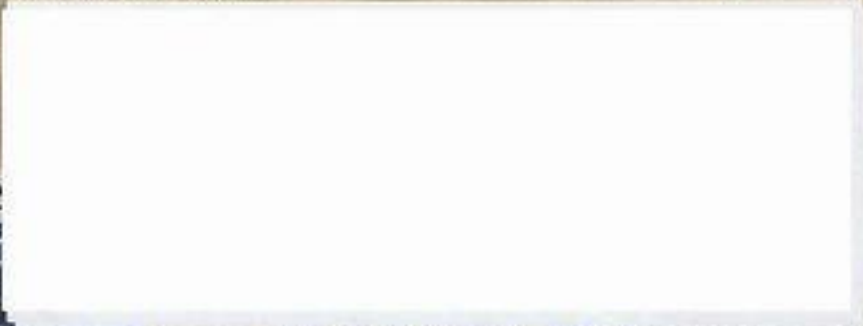

www.LEGOclub.com

Ultimate Vahki!

BIONICLE

When there's a danger too great for any Vahki squad to meet, Metru Nui relies on two ultimate Vahki machines for protection. But should these mechanical enforcers turn and betray the city, what power could stand against them?

Kranua

An extremely specialized Vahki model, the Kranua is called into action less often than the Kraahu. Powerful and bulky, the Kranua is capable of transforming its body into animated grains of protodermis. It can then flow through narrow cracks or vanish into the pavement, before reforming someplace else. This makes the Kranua highly effective at pursuing law-breakers into tiny spaces or confusing rampaging Rahi with its sudden disappearances and reappearances.

Build Kranua with the elements and instructions inside these three Vahki sets:



Nuurakh 8614 Vorzakh 8616 Rorzakh 8618

Kraahu

Unlike the Vahki, who have a central mechanism governing their intelligence, the Kraahu's knowledge centers are scattered throughout its body. The advantage of this? The Kraahu can actually split apart and send its individual pieces to act independently. This allows it to challenge multiple foes by sending all six legs off in six different directions, while its other components monitor the area and defend against attacks. As a single unit, the Kraahu is capable of sending out clouds of stun gas. Kraahu parts give off a powerful electrical charge when touched.

Build Kraahu with the elements and instructions inside these three Vahki sets:



Bardakh 8615 Zadakh 8617 Keerakh 8619

Access more information on the Vahki squads and the city of Metru Nui at www.LEGOclub.com

clubcode
BIONICLE





ARE THESE MARTIAN TRANSMISSIONS FROM ASTROBOTS BIFF AND SANDY? TOP SECRET ALPHA TEAM MISSION REPORTS? OR MUSHY LOVE LETTERS FROM ALL MY SECRET ADMIRERS? NO, THEY'RE IMPORTANT LETTERS FROM LEGO CLUB MEMBERS, AND ONE OF THEM COULD BE YOURS! JUST MAIL ME YOUR QUESTION, ALONG WITH YOUR NAME AND AGE, TO:

LEGO Mailbag
PO Box 1308
Enfield, CT 06083-1308

LEGO mailbag



I saw **BIONICLE: The Mask of Light** and it was awesome! I'm a big fan and I was wondering if they are making another movie.
Jerrod, 11

They sure are, Jerrod. Look for **BIONICLE 2: Legends of Metru Nui** on DVD and video this October, starring the Toa Metru, the Vahki, and other characters from the BIONICLE universe!



What does the name **LEGO** mean? Does it stand for something?
Lawrence, 9

It certainly does! LEGO comes from the Danish term "Leg Godt," which means "play well." Ole Kirk Christiansen, founder of the LEGO Company, came up with this perfect name way back in 1934, and since that time, LEGO toys have stood for just what the name says – playing well!



Do you have any brothers or sisters? What's your favorite LEGO set?
Caitlin, age 9

Yes, I have three brothers – Fredini, Eddini, and Jedini. And I think the new Alpha Team sets coming out this year are so cool, they're icy!



LEGO contents

Help the Knights Find the Magical Shield of Ages! Hidden in this issue of LEGO Magazine are four pieces of the Shield. Find them all and unscramble the letters for a secret **KNIGHTS' KINGDOM** message.

BY THE CODE, WHERE ARE WE?

THIS IS NOT THE CITADEL OF ORLAN 'TIS SOME SORT OF...MAGAZINE CONTENTS PAGE!



2
Map of Morcia
Portrait of a noble quest.



5
Knights Kingdom Challenge
The game of champions!



8
Desert Deep Freeze!
Can Alpha Team protect the planet from Ogel?



11
World City Needs a Hero!
Could you be the one?



12
Prehistoric Predator
Sink your teeth into this building challenge!



14
Cool Creations
Amazing models from LEGO Club members.



HEY, WHAT'S WITH THE FLOATING HEAD GUY?
PERHAPS THE SHIELD OF AGES HAS BEEN HIDDEN HERE. LET'S SEE WHAT WE CAN FIND, KNIGHTS!

THEY'LL NEVER FIND THE SHIELD. THANKS TO MY CUNNING PLAN!





KNIGHTS' KINGDOM

THE KINGDOM OF MORCIA

A land of endless magic and adventure. The good king has been replaced by the evil Vladek, and it is up to Four heroic Knights to Find the Heart of the Magical Shield and save their kingdom.

ORKOSAN PROVINCE
Home of Santis

BORDER AMBUSH 8778

A wicked Shadow Knight guards the rickety bridge to the Moorlands. Santis must defeat him to get the key!

THE DESOLATE MOORLANDS

Here be Monsters!

CITADEL OF ORLAN 8780

Challenges and mysteries await at the legendary Citadel of Orlan. Will the Knights' incredible skills be enough to gain the Heart of the Magical Shield?

Use Santis' strength to hurl a boulder!

Use the catapult to repel Vladek's attack!

Raise the bridge and scale the tower if you dare, but watch out for traps, spinning axes and the giant serpent's bite!

BANTERAS PROVINCE
Home of Rascus

ALENDAN PROVINCE
Home of Danju



CASTLE OF MORCIA - 8781
Vladek has transformed this noble castle into a dark fortress. Only the Knights can change it back!



The Knights begin their quest.

VLADEK ENCOUNTER - 8777

Danger lurks on the road to Morcia. Vladek wants the Heart, but Danju won't give it up easily!

TALONJAY PROVINCE
Home of Jayko



GRAND TOURNAMENT - 8779

The Grand Tournament will decide the fate of Morcia. Can Jayko finally defeat Vladek, or will evil triumph over all?

Launch the steeds for jousting action!

MORCIA

Who Will Be the Next Tournament Champion?

A tournament challenge is a true test of knightly skill. Knock your opponent's shield off before he can remove yours and you'll earn the respect and adoration of the crowd!



THESE FELLOWS SEEM STRANGELY FAMILIAR...

THEY'RE BIG, BUT I'LL BET I COULD TAKE 'EM.



Use the 3 special Knights' Kingdom game cards included with this month's LEGO magazine to play Knights' Kingdom Challenge! You'll find 3 more game cards inside every Knight's Kingdom set!

Attach game cards to your Knights for a whole new way to play! Knock off your opponent's shield to win the Challenge!

More Knight's Kingdom adventures await at www.LEGOclub.com CLUB CODE: **KNIGHTS**



Knights Kingdom Challenge Card Game

CHOOSE YOUR CHAMPION!

You can play KNIGHTS' KINGDOM CHALLENGE with any cards in your deck, but for an extra challenge, choose one Knight and pit his cards against your opponent's favorite. Who will you pick to be YOUR Champion?



Make Your Own Shield!

Here's your chance to make your own Knightly shield! Using this page or a photocopy, create a design for your shield. Have an adult cut out the shield (don't forget the hole in the middle!) and glue it to a piece of heavy paper or thin cardboard. You can attach your shield to a KNIGHTS' KINGDOM figure to use in adventures and tournament challenges!

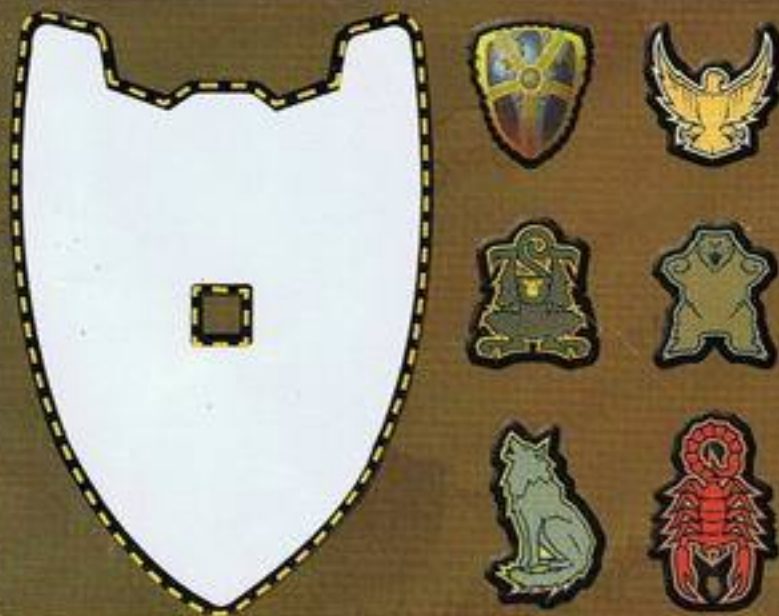

Rules

- Both players start with the same number of cards. Before playing, arrange your deck in any order you wish. Once the game starts, you can not change the order of your cards.
- Hold your cards with the SHIELD side facing your opponent. It's time for a JOUST! Call out the Joust symbol (SWORD, HELMET, SHIELD or HEART OF THE MAGICAL SHIELD) that appears at the top of the picture on the card. The player with the strongest symbol becomes the CHALLENGER, the other player is the DEFENDER. If both players have the same symbol, move those cards to the back of your decks and Joust again.

Joust Symbol Power Rankings:



- The CHALLENGER places their card down with the SHIELD side facing UP and says which SKILL they are using to Challenge: SPEED (Blue Hawk), STRENGTH (Red Bear), AGILITY (Green Monkey) or WISDOM (Purple Wolf).
- The DEFENDER places their card on top of the Challenger's card with the SHIELD side facing DOWN so that the POWER NUMBERS line up on the right side. The player with the highest POWER NUMBER in the Challenger's SKILL wins that challenge! If the numbers are the same, then both players return their cards to the back of their decks.
- If you win a Challenge, return your winning card to the back of your deck. Should you lose a challenge, you must put your card to the side. It cannot be used again in the current game.
- The game can last a set number of rounds or until one player has no more cards left. The player with the most cards left at the end of the game is the winner of the KNIGHTS' KINGDOM CHALLENGE!



GEAR UP FOR A CHANGE!

ALPHA TEAM'S NEW DOUBLE DUTY SPY SHUTTLES!

Alpha Team Agents Assemble!

Listen up! Ogel and his crew are planting ice orbs all over, stealing the heat right out of the air and turning the planet into an ice cube. Think you're ready to take him on? Then here's the latest Alpha Team tech to help you get the job done!



DASH JUSTICE
ALPHA TEAM COMMANDER



AT USER NAME >>> DASH



Chill Speeder

ALPHA TEAM VEHICLE CODE: 4742

MAX. SPEED: 150 mph/241 kmh

GEAR: Ice orb detector; stealth engine; radar; afterburner

ALPHA MODE: Hit the controls and it turns into an X-1 Snowbot Defender.

VEHICLE CLASS: Alpha Team junior agents start out on the Chill Speeder. The stealth engine keeps Ogel's icy creeps from hearing it until you're close enough to heat things up.



Ice Blade

ALPHA TEAM VEHICLE CODE: 4743

MAX. SPEED: 400 mph/643 kmh

GEAR: Ice orb detector; thermotronic runners; magma engine; radiant heat field

ALPHA MODE: Alters in seconds to sleek and powerful IC-2 helicopter.

VEHICLE CLASS: Prove you have what it takes to be an Alpha-4 agent and you could be piloting an Ice Blade. Just keep your mitts off the engine - it runs on molten lava and can turn an iceberg to ashes.



Tundra Tracker

ALPHA TEAM VEHICLE CODE: 4744

MAX. SPEED: 450 mph/724 kmh

GEAR: Magma powered drill; all-terrain permafrost tires; ice orb detector; radar; twin solar lasers; NW-1 magma engine

ALPHA MODE: Agent Gearbox designed this to change into an unstoppable drilling machine strong enough to split a mountain.

VEHICLE CLASS: Alpha-3 agents drive the Tundra Tracker, the toughest wheeled vehicle ever designed by the AT lab. Cuts through rock like a heat beam through a snowbank.



Blue Eagle

ALPHA TEAM VEHICLE CODE: 4745

MAX. SPEED: Mach 3.8

GEAR: Eagle claw; ice orb detector; stealth technology throughout; twin solar lasers; twin NW-3 magma engines; radar; thermal updraft generator

ALPHA MODE: Turns into a lightning fast Ice Glider for high speed pursuits on land.

VEHICLE CLASS: Make it to Alpha-2 and you're qualified to climb into the cockpit of the Blue Eagle. With its powerful Eagle claw, you can snatch Ogel's agents right off the ice. If enemy snowblasts force you down, transform into an Ice Glider and take them by surprise!

WANTED! THE SNOW CRAULER

ALPHA TEAM ENEMY ID CODE: 4745

We don't know much about them, other than that they have been spotted all over the world planting ice orbs. Bring one in intact and you'll be an Alpha Team hero.



>>>> ALPHA MODE



Mobile Command Center

ALPHA TEAM VEHICLE CODE: 4746

MAX. SPEED: 250 mph/402 kmh

GEAR: NW-2 magma engine; solar cannon; ice orb detector; ice orb crane; twin Alpha-1 snow sleds; stealth engine; radar

ALPHA MODE: Changes from a powerful truck into a fully-equipped command center.

VEHICLE CLASS: Only the best of the best get to operate the Mobile Command Center – the Alpha 1 agents! They have to be good, because Ogel would give his last snowball to get his hands on this monster.



>>>> ALPHA MODE





ALPHA TEAM

A HEAVILY ARMORED VEHICLE GLIDES, SWIFT AND SILENT, ACROSS A VAST LAND OF SNOW, ICE AND FREEZING COLD ...



HARD TO BELIEVE THIS WAS A DESERT AN HOUR AGO!

DASH, DO YOU READ ME? OGEL AND HIS ICE DRONES ARE TRYING TO FREEZE THE WORLD - AND WE DON'T HAVE ENOUGH ALPHA TEAM AGENTS TO STOP HIM!

INSIDE THE VEHICLE - ALPHA TEAM MOBILE COMMAND CENTER!



ROGER! WE NEED TO RECRUIT MORE AGENTS, AND FAST!



WHOA, RADIA! YOU'RE NOT GOING TO BELIEVE - WAIT!



ONE OGEL SNOW CRAWLER WITH ICE ORB SPOTTED BELOW! I'M IN PURSUIT!

DASH PILOTS THE BLUE EAGLE, SEARCHING FOR SIGNS OF OGEL AND HIS DRONES...SUDDENLY THE CANYON FREEZES!



BEFORE DASH'S EYES, THE OGEL ORB TURNS THE LAND ALL AROUND INTO AN ICEBOX!



THINK YOU CAN ESCAPE THE BLUE EAGLE, DO YOU? INITIATE ALPHA MODE!!!



...ALPHA MODE INITIATED...



YOU WON'T GET AWAY FROM MY ICE GLIDER!



MEANWHILE, ON THE FAR SIDE OF THE WORLD, AGENT ARROW PILOTS THE ICE BLADE IN SEARCH OF OGEL'S SECRET BASE...



HIGH ABOVE, THREE OGEL SNOW CRAWLERS ARE UP TO THEIR USUAL NO-GOOD...

Rummbble!!

ARROW TO RADIA, WE COULD HAVE ONE HECK OF A SNOWBALL FIGHT DOWN HERE - BUT OGEL WOULD PROBABLY TRY TO CHEAT.

HA! IF THOSE DRONES THINK THEY CAN STOP ME WITH A LITTLE SNOW, THEIR BRAINS ARE FROZEN. INITIATE ALPHA MODE!!!

SWOOSH!

TRANSFORMATION COMPLETE ZOOM 2 X



... UP AND OVER I GO!



No!

ZZZ-ZAP!

RADIA TO ALPHA TEAM!
IT LOOKS LIKE OGEL'S UP TO
SOMETHING A LOT BIGGER THAN JUST
SPREADING ICE AND SNOW!
HE'S PLANNING TO -



IN THE FLASH-FROZEN DESERT,
RADIA SENDS AN URGENT MESSAGE ...

I HAVE A PLAN SO COOL
IT'S FROZEN SOLID ... AND NOT
EVEN ALPHA TEAM CAN
STOP ME NOW!

NOW, NOW, I CAN'T HAVE YOU
GIVING AWAY MY SURPRISES. YOU WILL BE
SAFE AND SOUND INSIDE THIS ICE BLOCK -
AND SOON THE REST OF YOUR TEAM
WILL JOIN YOU!



**HELP RESCUE RADIA FROM
FROM A FROSTY FATE!**

Log on to
www.LEGO.com/ALPHATEAM
to become an Alpha team agent!

Can you **SAVE** World City?

You could win one of 50
Rescue Chopper or
Fire Command
Craft sets!

LEGO

World City 

All entries
must be
received by
**September 1st,
2004!**

World City is facing its greatest crisis ever! The Rescue Chopper and Fire Command Craft are on their way to the rescue! But they need your help to save the day!

Choose either the Rescue Chopper or the Fire Command Craft and write a story (no more than 150 words) about World City's emergency and how this rescue vehicle saves the city. Be as crazy and creative as you want!

How to Enter

1. Choose one of the two World City rescue vehicles to be the star of your story.
2. Write a story of no more than 150 words (please print) detailing the emergency World City faces and how the vehicle you chose helps to save the day.
3. Be sure to include your name, age, mailing address and phone number with your story.
4. Send your story to:

LEGO World City Rescue Contest
PO Box 1625
Enfield, CT 06083

Official Rules

NO PURCHASE NECESSARY. All entries must be received by midnight EST, September 1st 2004. Offer void where prohibited by law. All US, federal, state and local rules apply. Employees of LEGO Systems Inc. and its affiliates and subsidiaries and their immediate families are not eligible to participate. Entries will be judged based on creativity (70%) and description of the solution to the crisis (30%). Estimated total value of winning prizes: Rescue Chopper \$19.99, Fire Command Craft \$29.99. LEGO Systems Inc. and its affiliates and subsidiaries are not responsible for lost, mislaid, or damaged entries. Entries will not be returned and become the property of LEGO Systems Inc. By participating in this contest, entrants agree to be bound by the official rules and decisions of the judges.

A CITY IN NEED OF
SAVING? THIS LOOKS LIKE
A JOB FOR THE
KNIGHTS!

MAYBE WE
SHOULD FINISH SAVING
MORCIA FIRST.

TIME TO SPRING
MY TRAP!

 you can build this

BEWARE THE JAW OF THE KRONOSAURUS!

More than 30 Feet long, this giant marine reptile prowled the prehistoric seas during the age of dinosaurs, searching for food with the help of four powerful flippers.

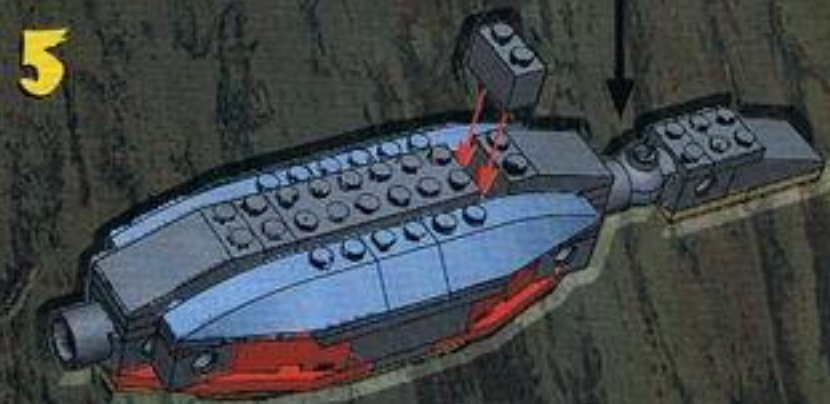
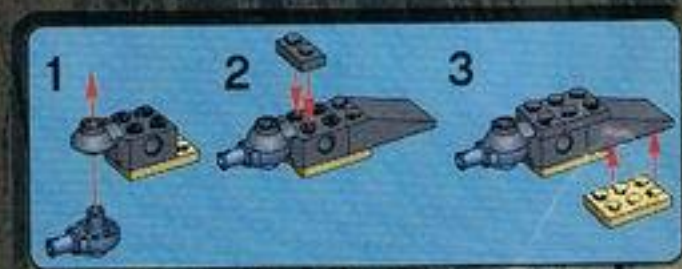

You can build your own Kronosaurus using parts from 4506 Deep Sea Predators and 4507 Prehistoric Creatures!

WHAT WILL YOU MAKE?



4506

+



4507

=



WHAT WILL YOU MAKE?

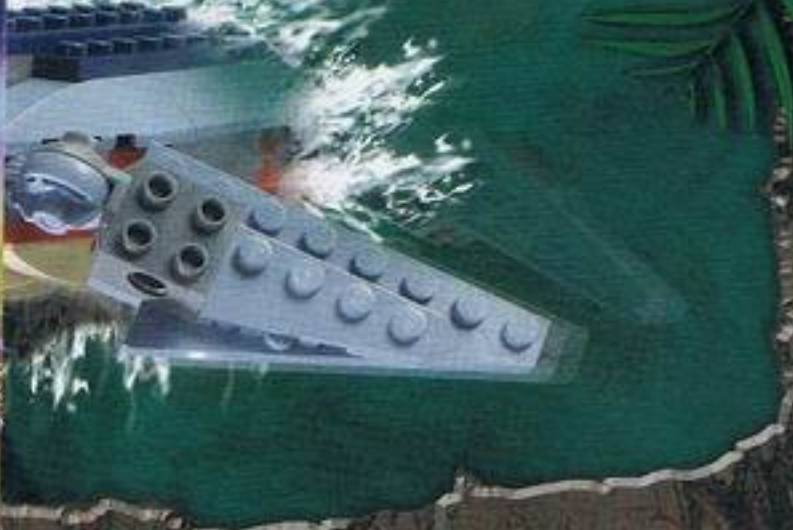

1

2

3

4

1

2

4

1

2

3

4

5

7

6

8

These sets include step-by-step plans for 18 different Dino and Sea Creature models plus 45 more cool building ideas!





GREETINGS, ROYAL SUBJECTS!
IT IS I, KING MATHIAS. I'VE TAKEN A BREAK FROM RULING MORCIA TO SHARE SOME WONDERFUL NEW CREATIONS WITH YOU, SENT IN BY FELLOW READERS OF THIS VERY MAGAZINE! IF YOU'D LIKE TO SHOW OFF YOUR OWN "COOL CREATIONS," WHY NOT SEND US A PICTURE? YOUR MASTERPIECE MAY JUST APPEAR IN A FUTURE ISSUE OF LEGO® MAGAZINE!

Send photos of your masterpiece models to:



Cool Creations
LEGO Club
P.O. Box 1308
Enfield, CT 06083-1308

Remember to include your name, age, address and the name of your model. No Polaroids or computer print-outs please! Pictures will not be returned, so take an extra photo for yourself.



Bass
Evan and Jeremy Stumpges, 13 & 12
California

See more models from kids just like you on the official Web site of the LEGO Club!

clubcode

COOLCREATIONS

www.LEGOclub.com



Space Station
Max Schellenberg, Ontario



Spider-Man
Joshua Barnes, 10, Nevada



Viking Ship
Breanna Beauchamp, 5, California





Rohkshi Rover
Ian Charles, 8, Texas



United States
Ross Treadway, 12, Maine



Clickling Bros. and Blockum & Brickly Circus
Adam and Danielle Vera, 11 & 9, Texas



EiFFel Tower, Ben Ostland, 8, California



BIONICLE™ Halloween Costume
Colin Griffin, 6, Illinois



Tire Factory
Josiah Janecek, 12, Iowa



Amazing Redini
Lucas, 11, Indianapolis



LEGO Newsflash

BUILDING A BETTER TOMORROW ONE BRICK AT A TIME
Volume MMIV Number 4



BIONICLE™ Blasts Off at Comic-Con



Every year, thousands of people from all over the world gather at the San Diego Convention Center to attend Comic-Con International, the biggest comic and pop culture show in the US! Now the Toa Metru are leaving the City of Legends and heading there as well, as BIONICLE comes to Comic-Con on July 22-25.

guests such as comic writer Greg Farshtey, comic designer Toby Dutkiewicz and BIONICLE.com producer Leah Weston. Also on tap, a sneak peek at scenes from the upcoming movie BIONICLE 2: Legends of Metru Nui! For more information, check out www.BIONICLE.com or www.comic-con.org.

BIONICLE fans at this year's Comic-Con will have the chance to meet special



LEGO® Star Wars™ Vader Invades San Diego!

LEGO Star Wars™ fans at Comic-Con will be in for a surprise of galactic proportions – when they suddenly find themselves, face-to-face, with a life-size LEGO brick model of Darth Vader! A full scale R2-D2 will be on display as well, along with detailed LEGO dioramas highlighting scenes from the various Star Wars™ movies.

Con will also receive free mini-TIE fighters (supplies are limited), and get a first look at the newly modified LEGO Millennium Falcon™. This LEGO model, featuring tons of authentic details and a new mini-figure crew, won't be appearing in stores until next August – but LEGO Star Wars™ fans will have a chance to win one of six advance models to be given away during Comic-Con.

Visitors to the Lucas-sponsored Star Wars™ booth at Comic-

New at LEGO.com!

WORLDBUILDERS WANTED!
So you've managed to speed past those pesky deconstructing crabs? You've mastered the mighty Trebuchet? You're a class four World Builder? Well... get ready for some amazing new adventures in the World Builder Expansion featuring the challenging new Ocean and Prehistoric Worlds!
CLUB CODE: WORLDBUILDER
www.LEGOclub.com

FREE BRICKS!
Ever wonder what it would be like to have a virtually unlimited collection of LEGO bricks right at your fingertips? With LEGO Digital Designer, you can stop wondering and start building! It has everything you need to design and construct cool LEGO creations right on your computer using virtual 3D elements. And right now you can download LEGO Digital Designer 1.1 for free!
CLUBCODE: DIGITALDESIGNER
www.LEGOclub.com

SOLVE THE SHIELD!



DID YOU FIND ALL OF THE FRAGMENTS OF THE MAGICAL SHIELD? UNSCRAMBLE THE LETTERS ON THE PIECES FOR A SECRET MESSAGE FROM THE KNIGHTS!



Coming in August...

Look for specially marked Tropicana Pure Premium® Healthy Kids™ orange juice to find out how you can receive a FREE LEGO® Dino set!

PLUS, just by entering you could WIN an Ultimate LEGO® prize package!



LETTER SCRAMBLE SOLUTION:
3000 3HL 0N0H

ALL NEW!**Order Today! Call 1-800-453-4652**

Or visit the secret clubshop page online and order there!

www.LEGOshop.com/clubshop

source code

SP704**LEGO** **Knights' Kingdom****Challenge an evil Shadow Knight!**

A dread Shadow Knight waits to ambush brave Knight Santis near a rickety vine bridge. Will Santis win the battle or will he fail in his quest? Includes Santis and Shadow Knight. Ages 6+.

#8778C Border Ambush \$19.99



FREE pack of 6 unique game CARDS with purchase of #8778C – including cards #79 & #80, two of the most powerful in the Knights' Kingdom card game!

**LEGO** **ALPHA TEAM****Save the world in the Ice Blade!**

The Ice Blade searches the frozen tundra for evil Ogel's powerful ice orbs. When trouble appears, the pilot initiates Alpha mode and changes the Ice Blade into a stealth helicopter! Includes ALPHA TEAM agent Arrow.

#4743 Ice Blade \$9.99

Transforms into a stealth helicopter!

Includes ice orb!

To order, call 1-800-453-4652 24 hours a day

Please make check or money order payable to LEGO® Shop At Home.

Item #	Description	Price	Qty	Total
#8778C	Border Ambush	\$19.99		
Bonus pack of game cards		FREE!	One per order of #8778C	
#4743	Ice Blade	\$9.99		
Subtotal				
(Connecticut residents, please add 6% sales tax)				
Regular Shipping (special for this Club offer only)				\$2.95
Total				

(Please do not send cash.)
*Please allow 2 weeks for delivery. Offer good through 8/15/04 or while supplies last.

(Connecticut residents, please add 6% sales tax)
Regular Shipping (special for this Club offer only)

100% LEGO® Quality and Service Guarantee

We believe our toys and our service must live up to your highest expectations. If for any reason you're not satisfied with your order, just return it to us for replacement, exchange or a prompt refund.

Mail To:
LEGO® Club
P.O. Box 1308
Enfield, CT 06083-1308

One bonus pack of game cards included with purchase of each item #8778C while supplies last. Not good with any other offer. Offer valid in U.S. and Canada. Offer good through September 15, 2004. LEGO, the LEGO logo, LEGOLAND are trademarks of the LEGO Group. ©2004 The LEGO Group.

Please print:

Name _____

Address _____

City _____ State _____

Zip _____

Daytime Phone (____) _____

Method Of Payment

<input type="checkbox"/> MasterCard	<input type="checkbox"/> VISA	<input type="checkbox"/> Discover	<input type="checkbox"/> American Express
Account Number	____	____	____
Expiration Date			____ / ____
Signature			____
Printed Name			____
Address of Cardholder			____

Enter 3 digits for Discover Cards only.

SP704

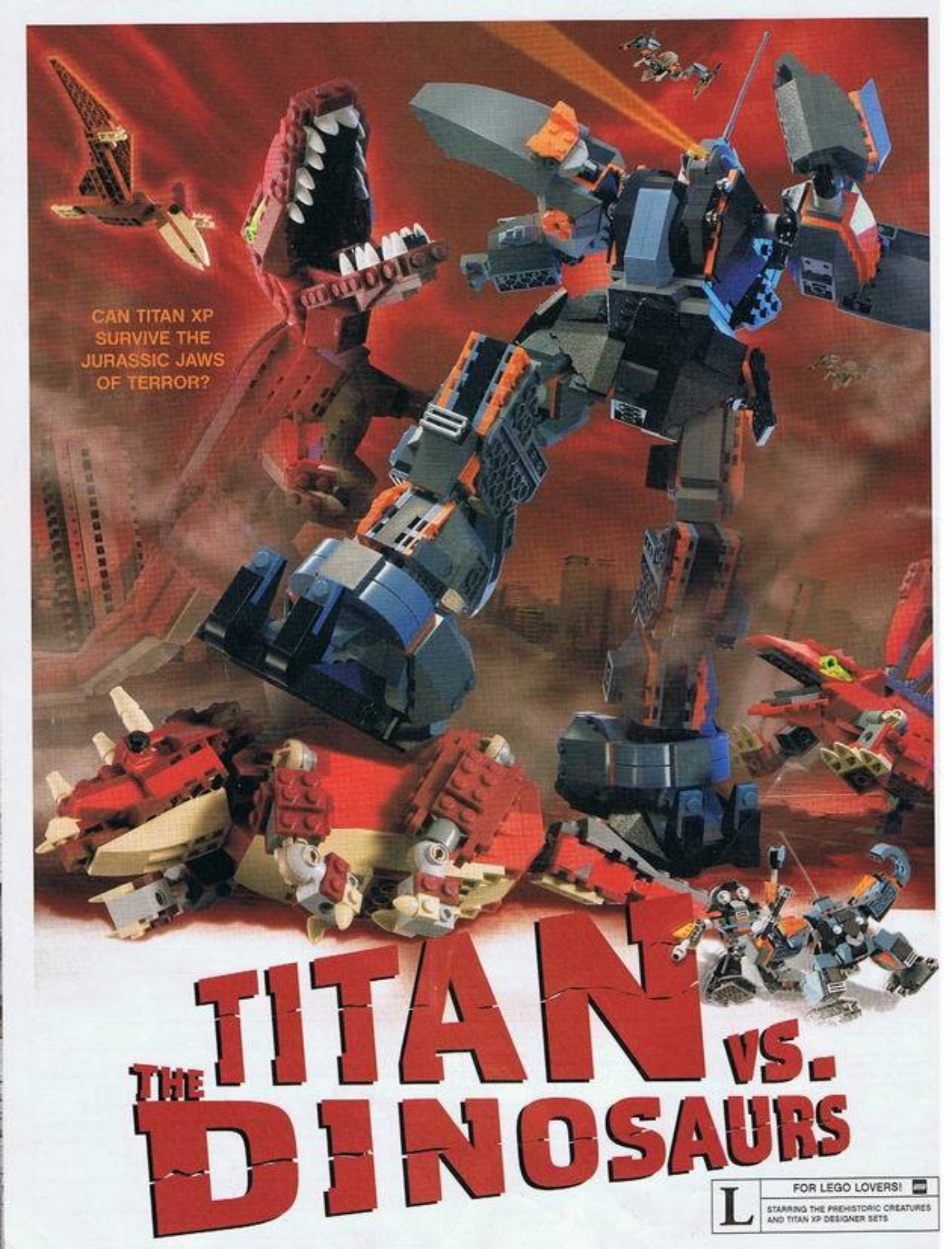
A promotional image for the LEGO Titan XP vs. Dinosaurs set. The central focus is the Titan XP robot, a large grey and blue mechanical figure with a checkered pattern on its chest, standing in a dynamic pose. To its left is a large, red and black dinosaur head with sharp teeth. In the upper left, a brown and yellow Pterodactyl is shown in flight. The background is a reddish, hazy landscape with a cityscape and a small helicopter. At the bottom, there are several smaller LEGO sets, including a red and yellow dinosaur and a small robot. The overall scene is dramatic and action-oriented.

CAN TITAN XP
SURVIVE THE
JURASSIC JAWS
OF TERROR?

THE TITAN vs. DINOSAURS

L

FOR LEGO LOVERS!

STARRING THE PREHISTORIC CREATURES
AND TITAN XP DESIGNER SETS